

**根据组合体的两个视图  
和直观图画出第三视图**

3-4-1-1 根据组合体的两个视图和直观图画出第三视图

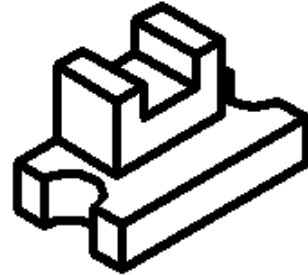

3-4-1-2 根据组合体的两个视图和直观图画出第三视图

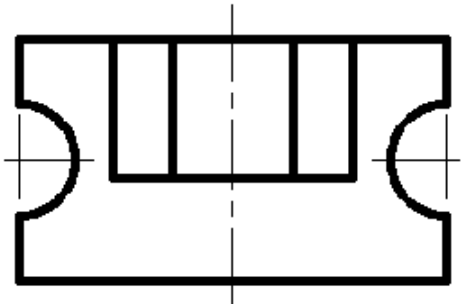
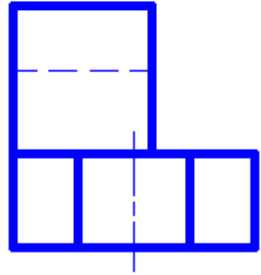
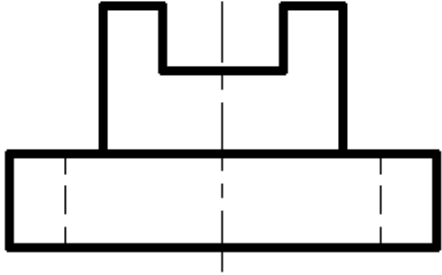
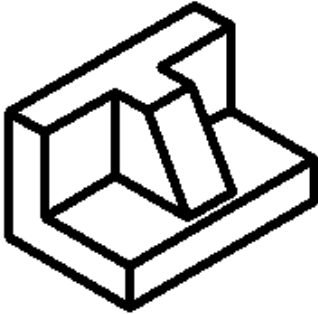
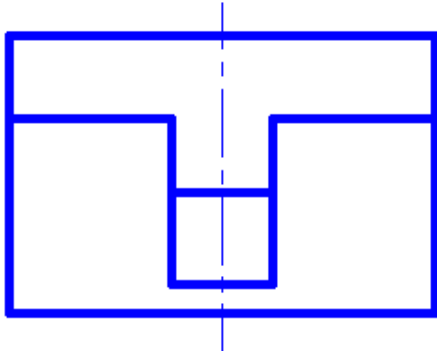
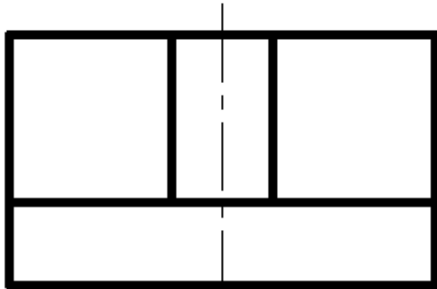

3-4-1-3 根据组合体的两个视图和直观图画出第三视图

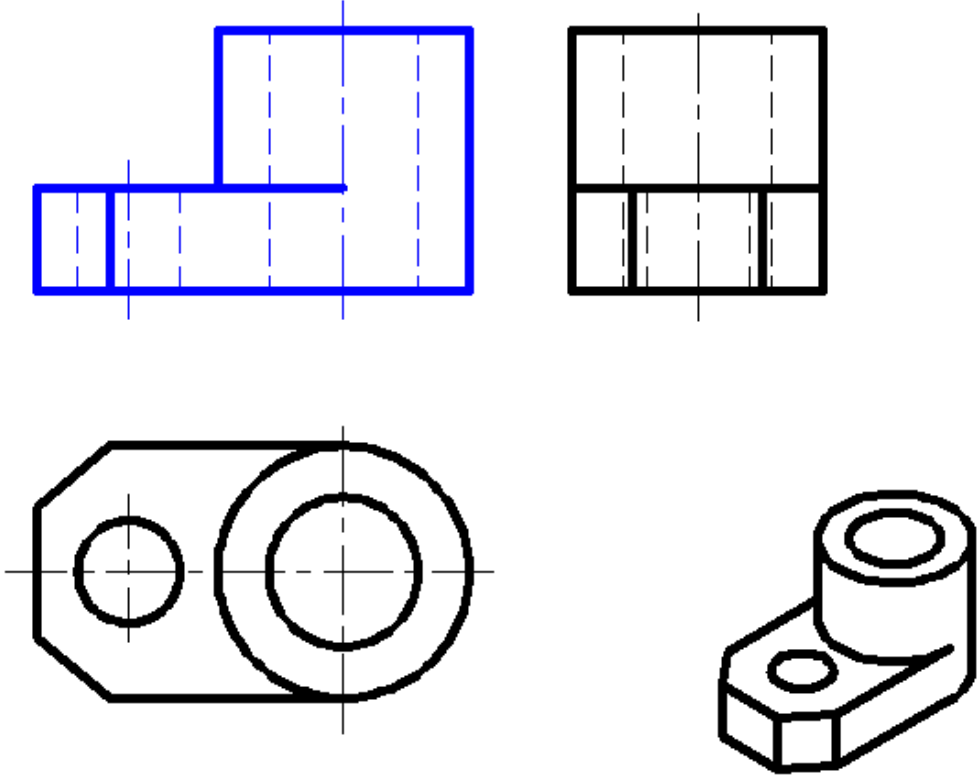

3-4-1-4 根据组合体的两个视图和直观图画出第三视图

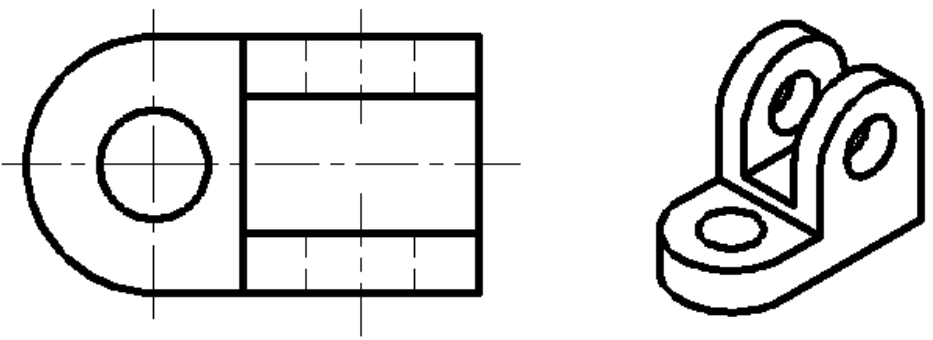
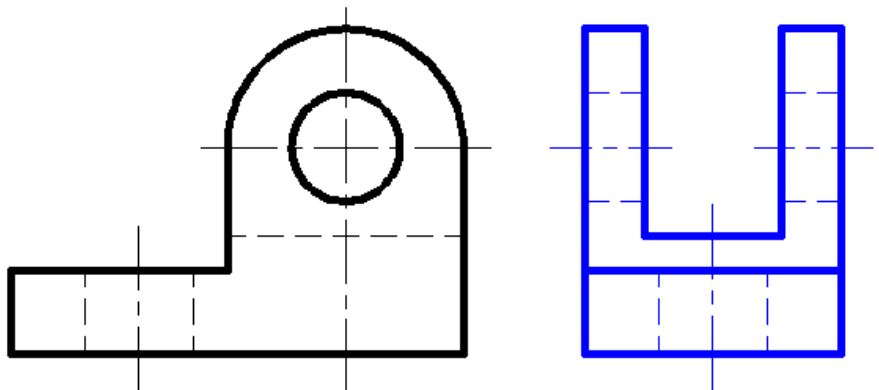

3-4-1-5 根据组合体的两个视图和直观图画出第三视图

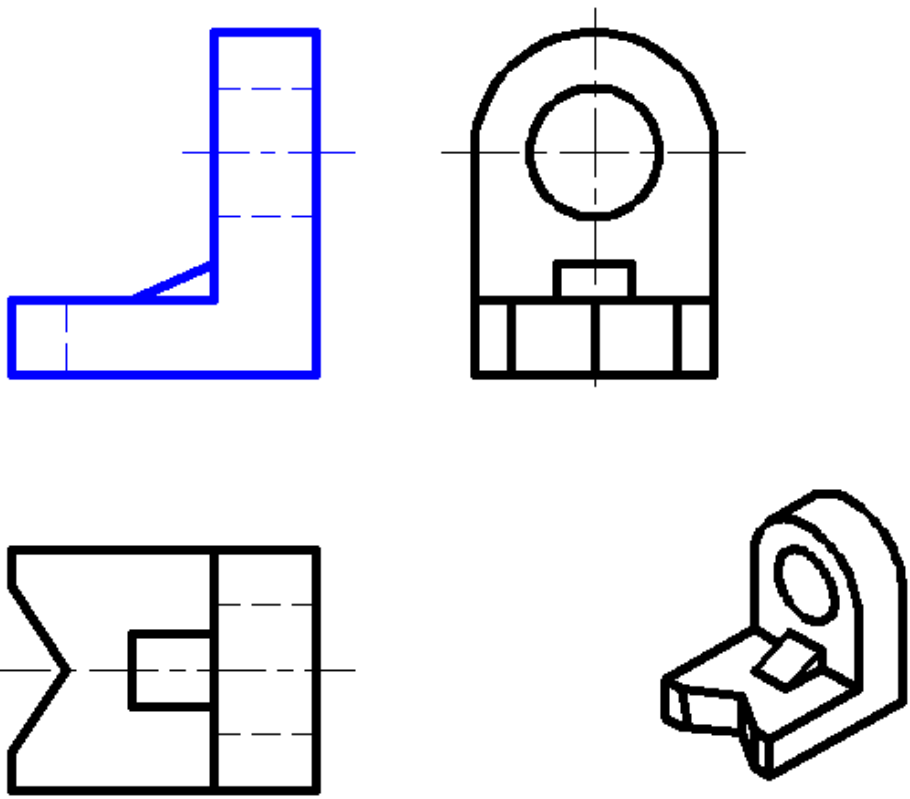

3-4-1-6 根据组合体的两个视图和直观图画出第三视图

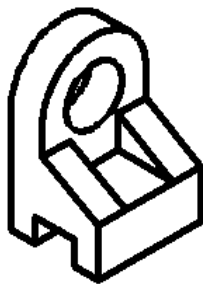
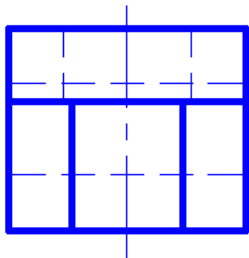
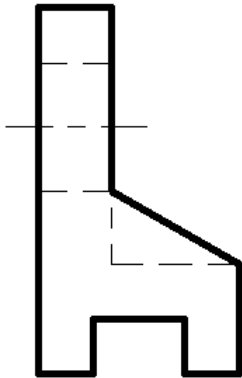
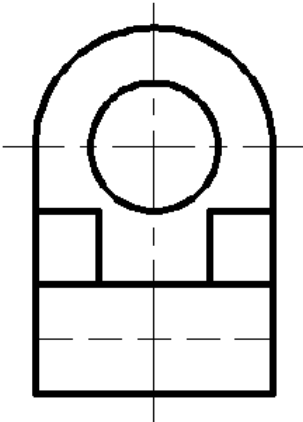

**根据组合体的两个视图  
画出第三视图**



3-4-2-1 根据组合体的两个视图画出第三视图

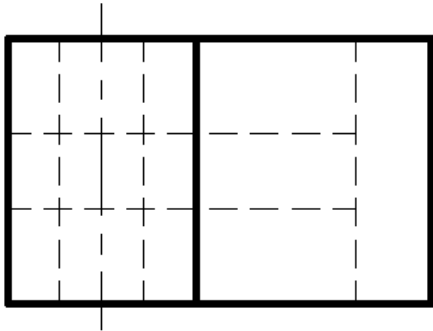
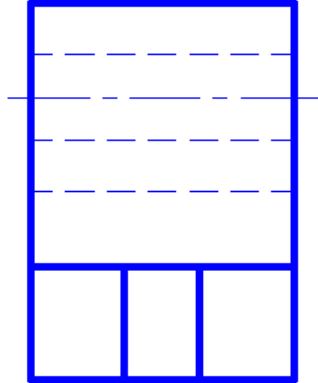
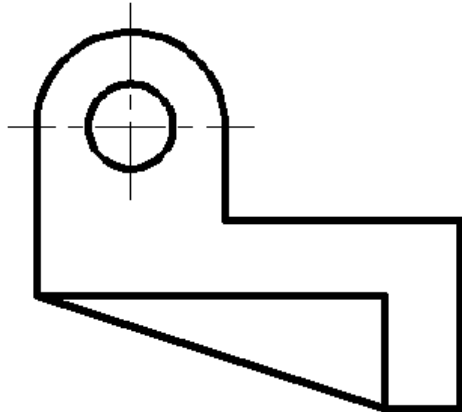

3-4-2-2 根据组合体的两个视图画出第三视图

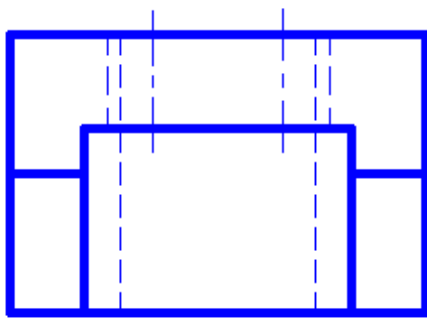
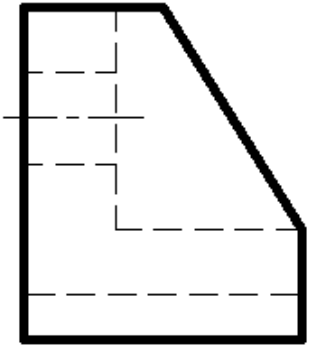
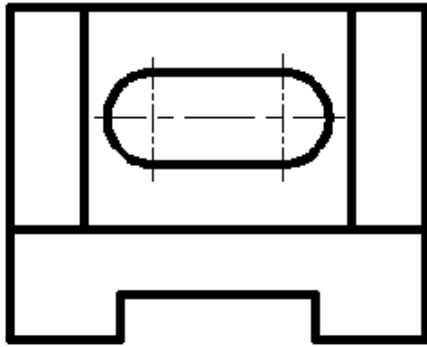

3-4-2-3 根据组合体的两个视图画出第三视图

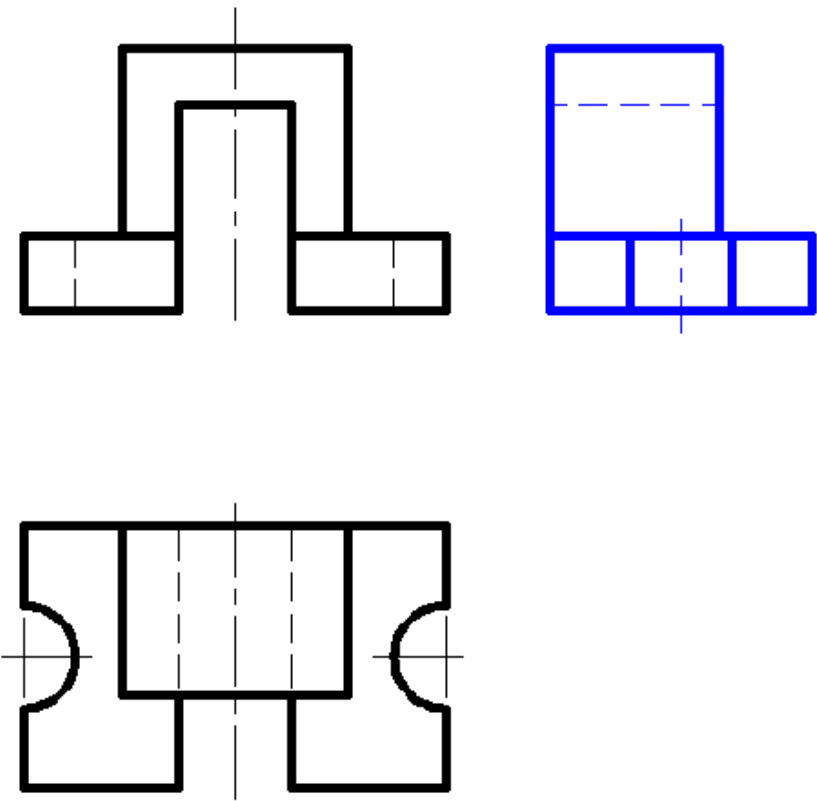

3-4-2-4 根据组合体的两个视图画出第三视图

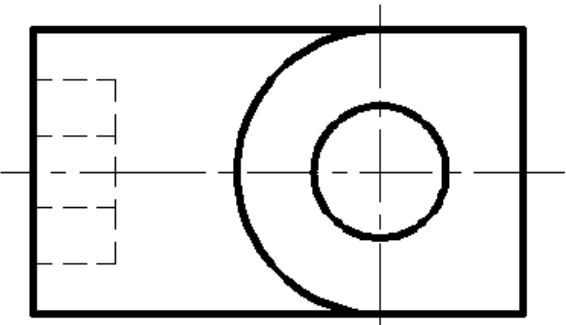
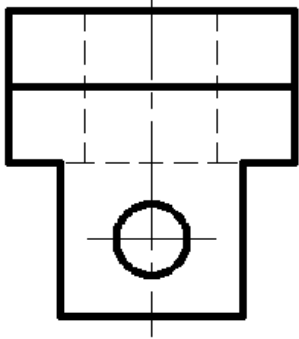
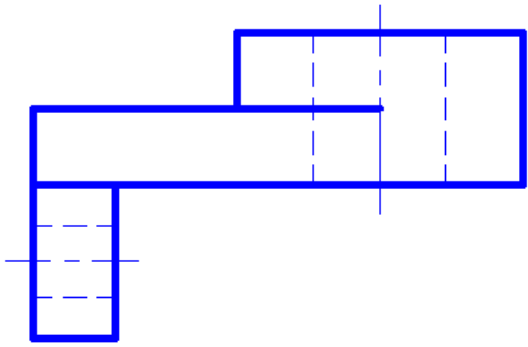

3-4-2-5 根据组合体的两个视图画出第三视图

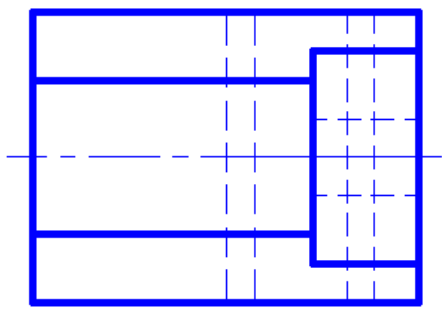
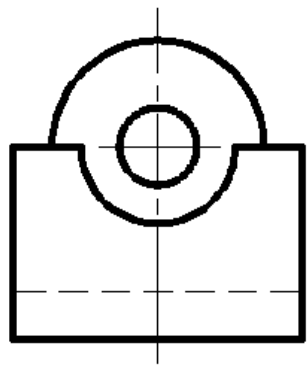
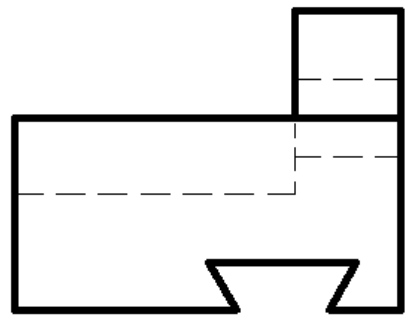

3-4-2-6 根据组合体的两个视图画出第三视图

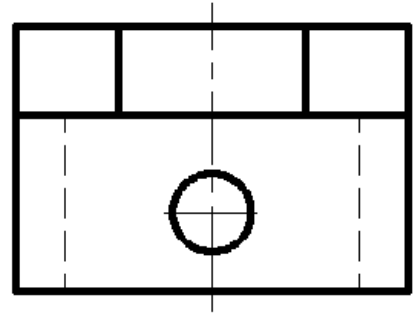
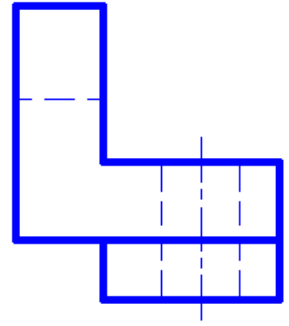
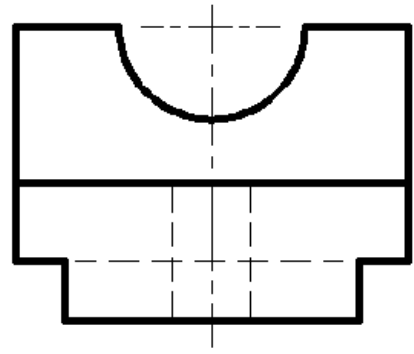

3-4-2-7 根据组合体的两个视图画出第三视图

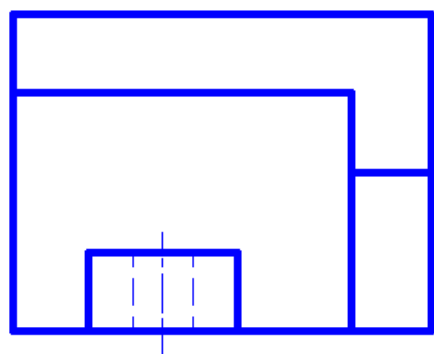
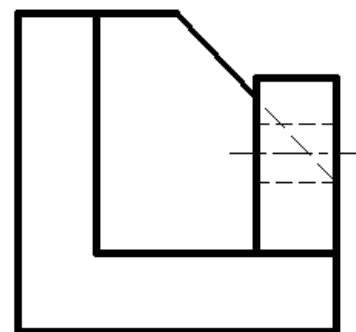
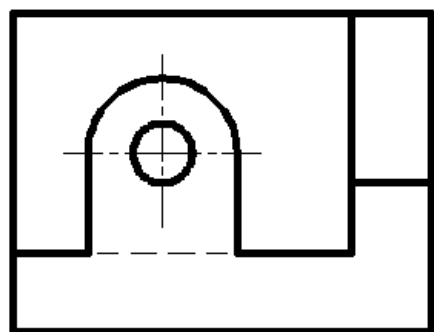

3-4-2-8 根据组合体的两个视图画出第三视图

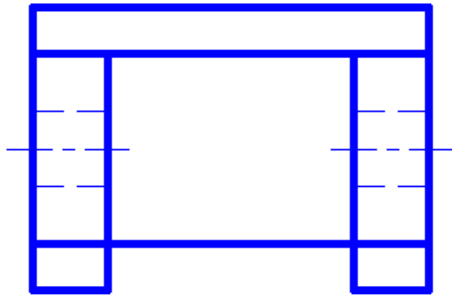
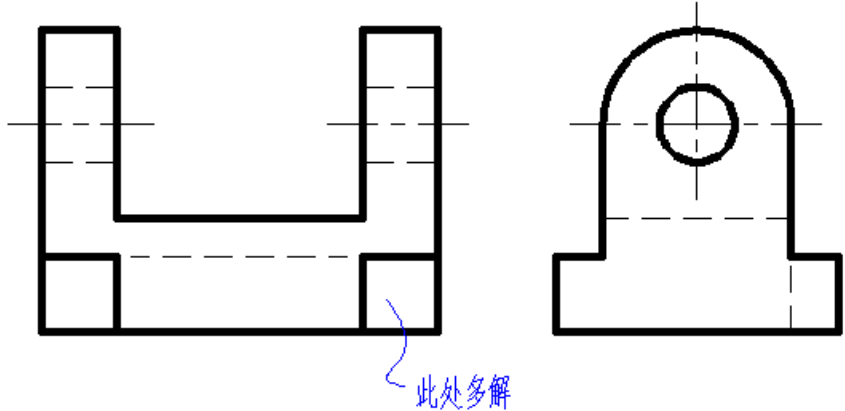



3-4-2-9 根据组合体的两个视图画出第三视图

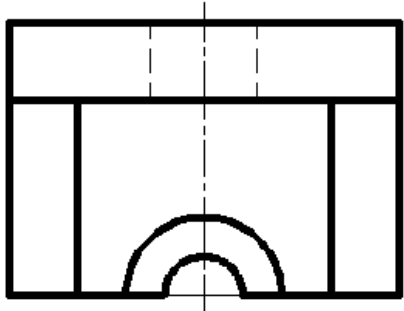
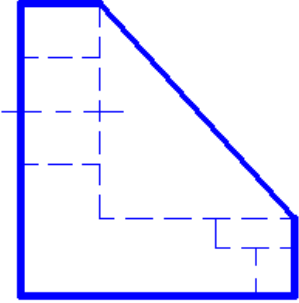
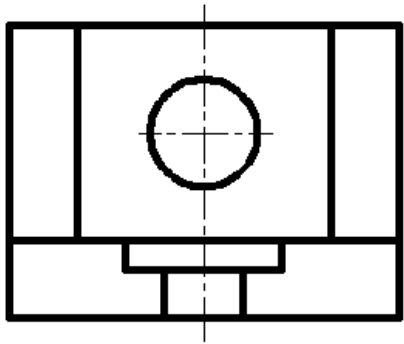

3-4-2-10 根据组合体的两个视图画出第三视图

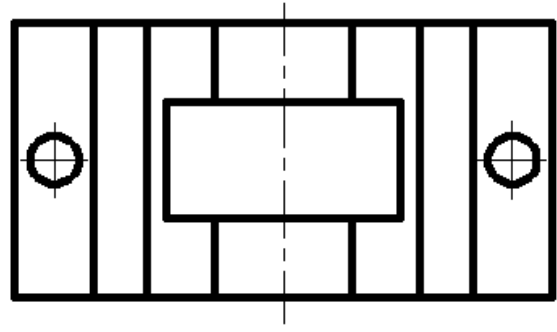
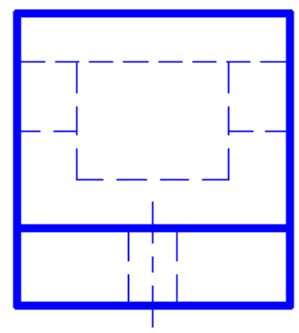
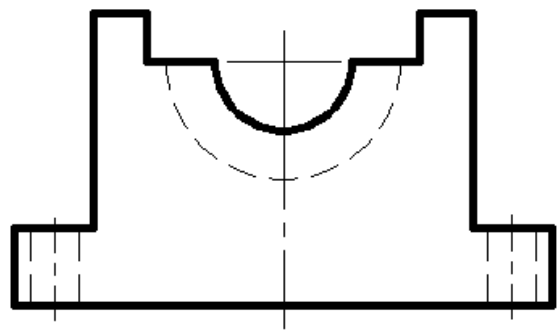

3-4-2-11 根据组合体的两个视图画出第三视图

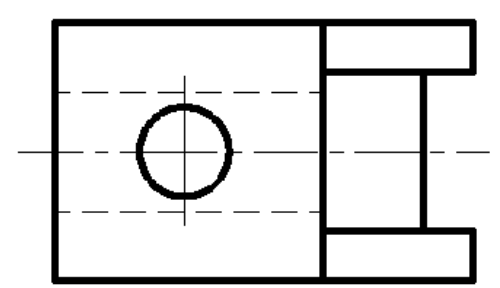
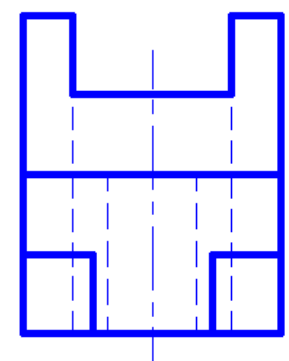
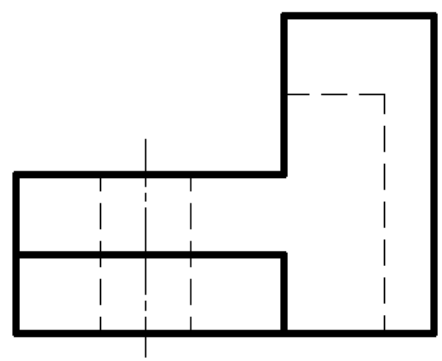

3-4-2-12 根据组合体的两个视图画出第三视图

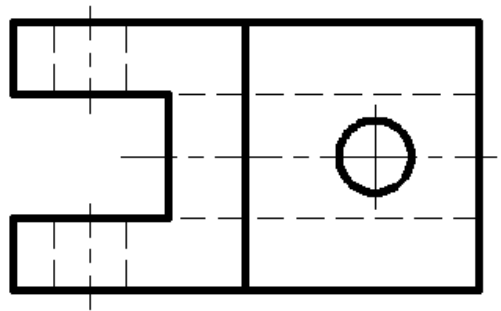
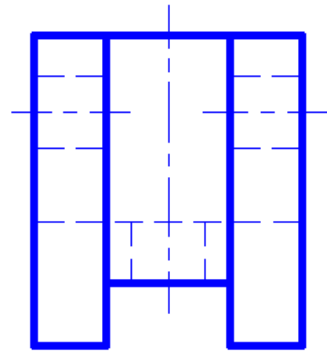
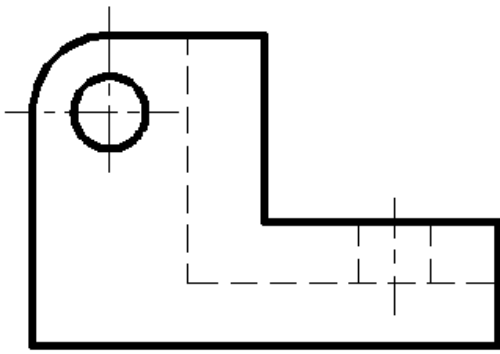

3-4-2-13 根据组合体的两个视图画出第三视图

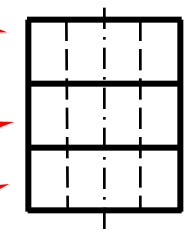
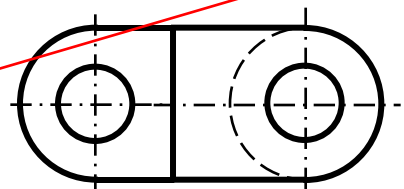
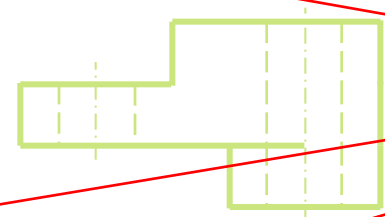
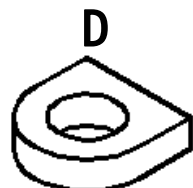
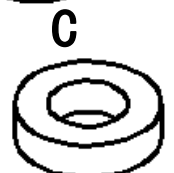
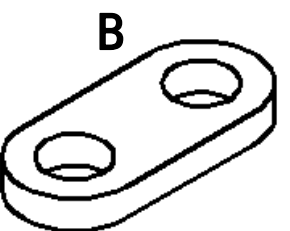
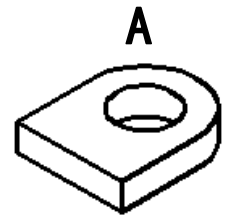

结合俯视图，  
三层结构为：  
A、B、C

各层还可能结构为  
D、E.....

由侧视图判断：  
三层结构

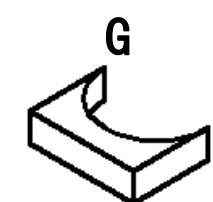
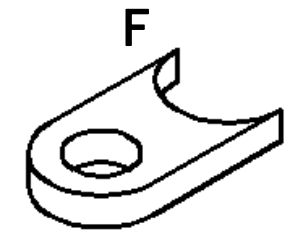
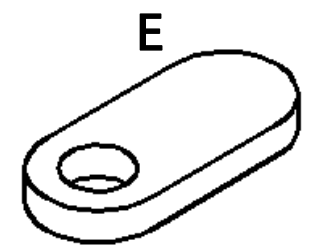

3-4-2-13 根据组合体的两个视图画出第三视图

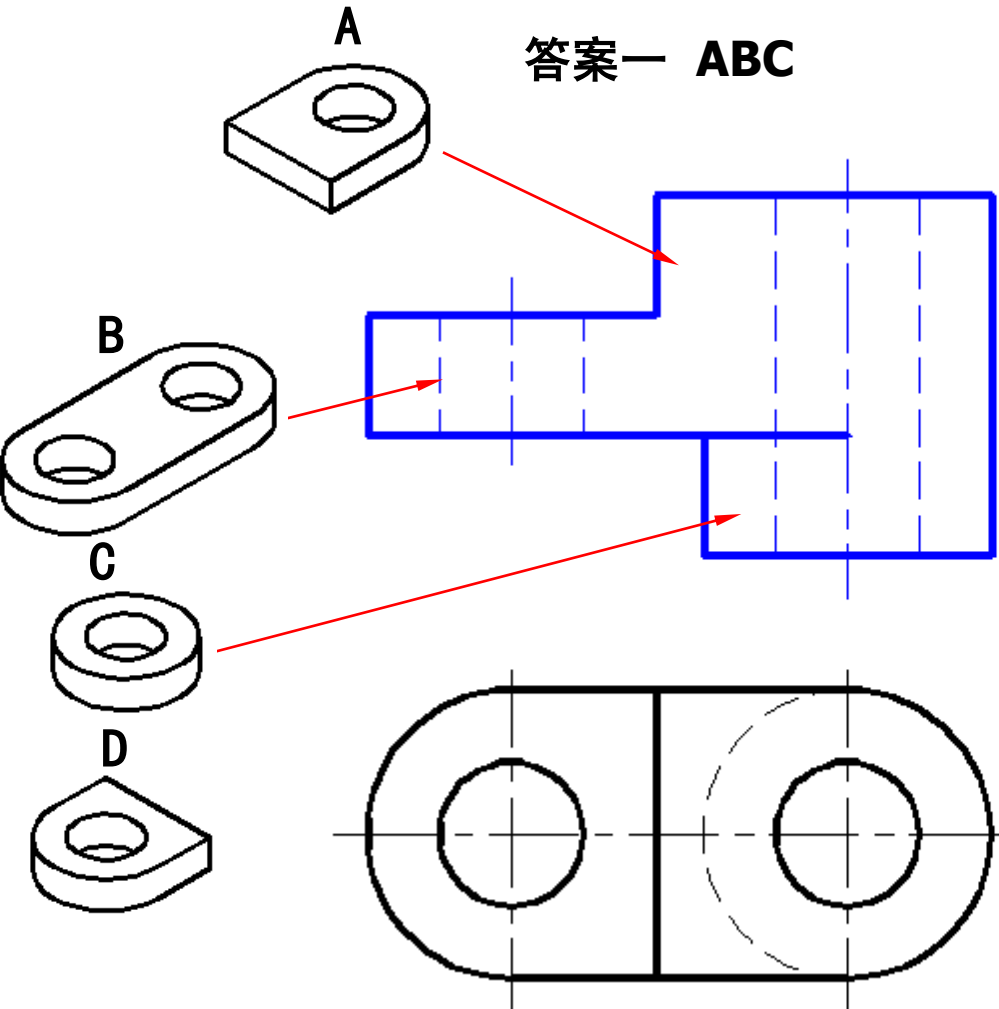

答案一 ABC

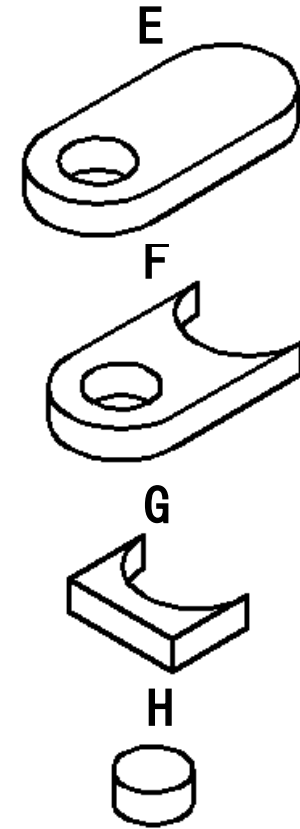

3-4-2-13 根据组合体的两个视图画出第三视图

答案二 ACB

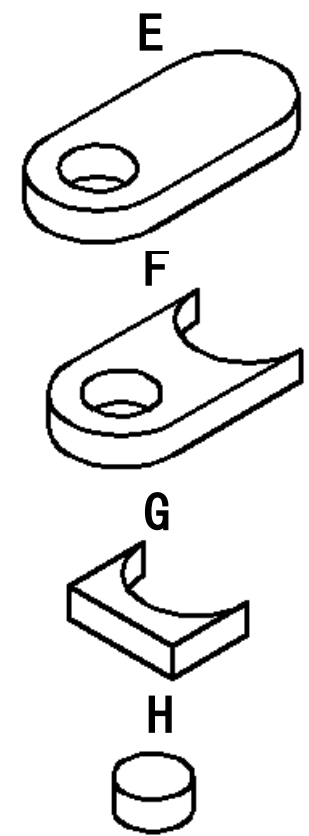
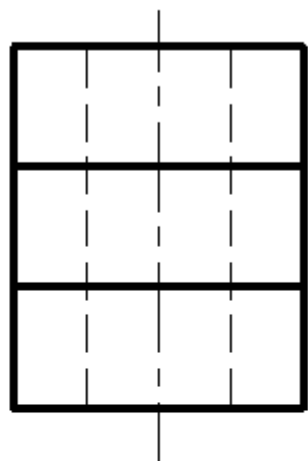
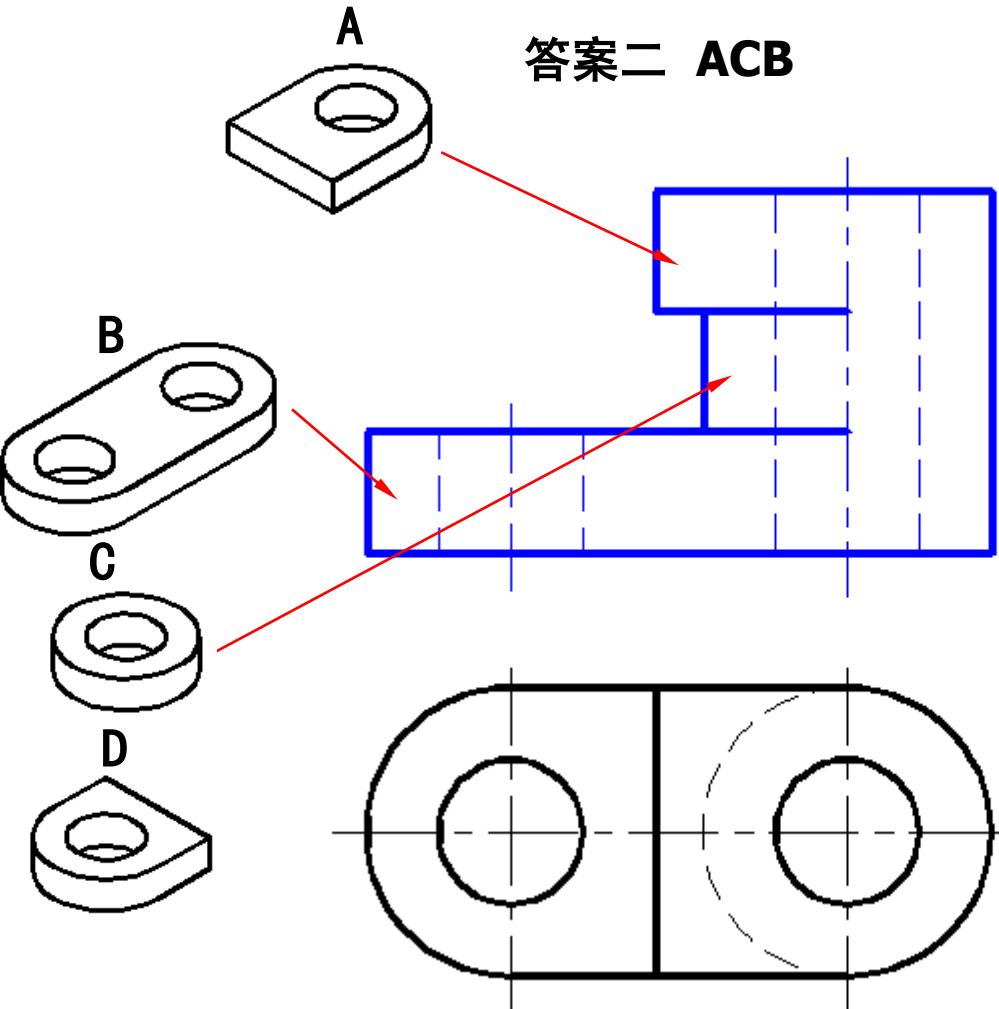

3-4-2-13 根据组合体的两个视图画出第三视图

答案三 AEC

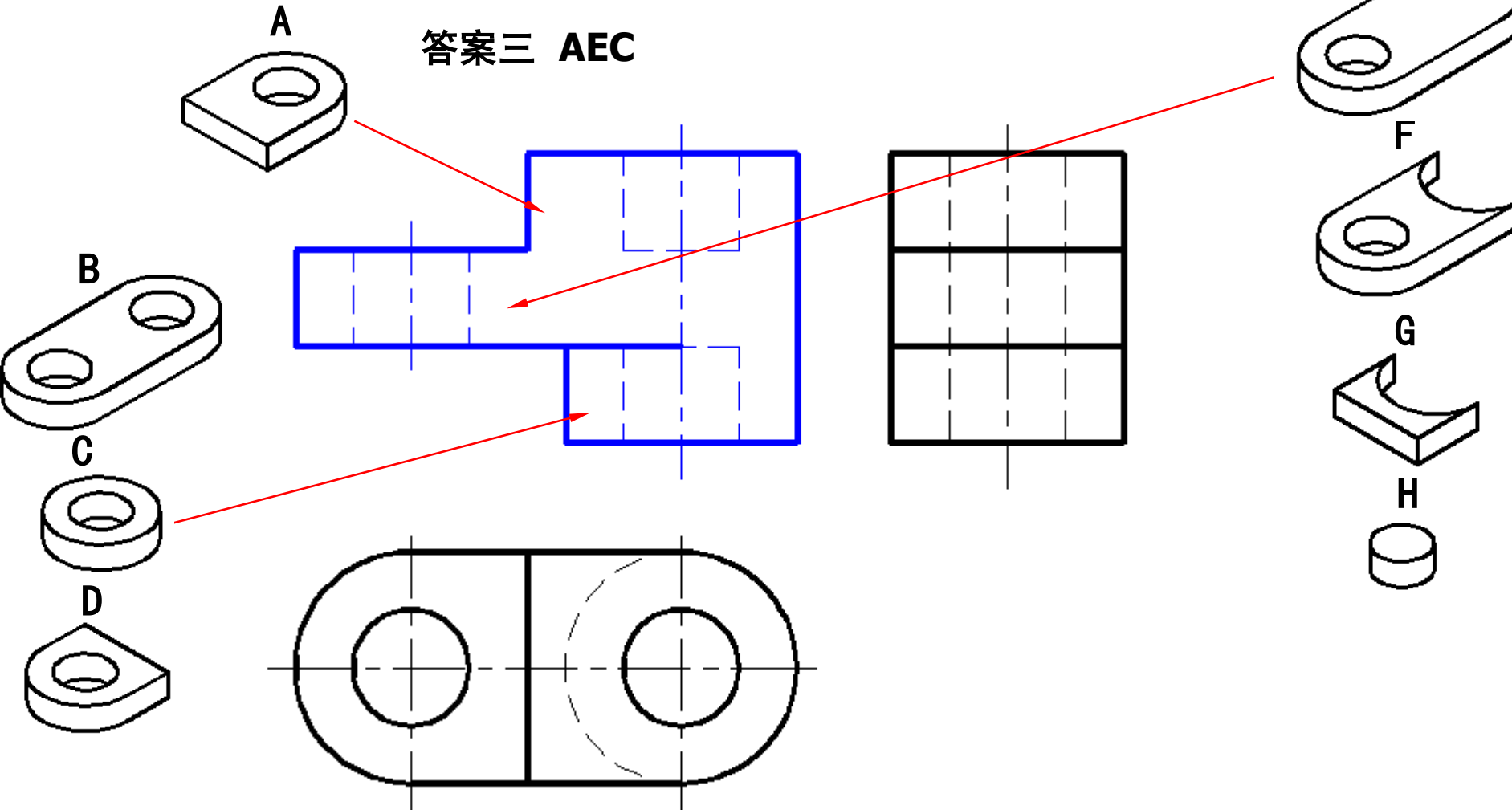



3-4-2-13 根据组合体的两个视图画出第三视图

答案四 ACE

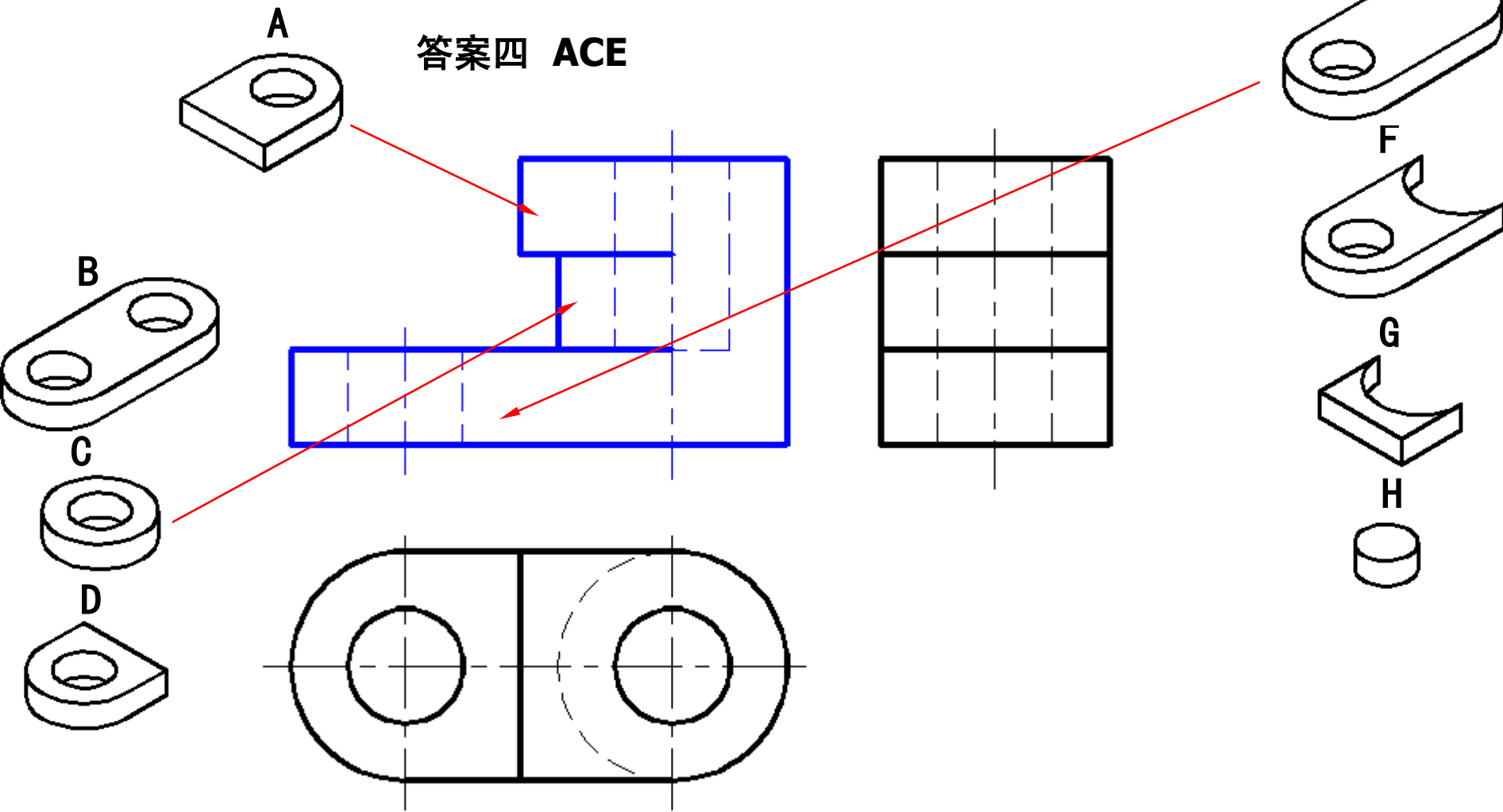

3-4-2-13 根据组合体的两个视图画出第三视图

答案五 AE (GH)

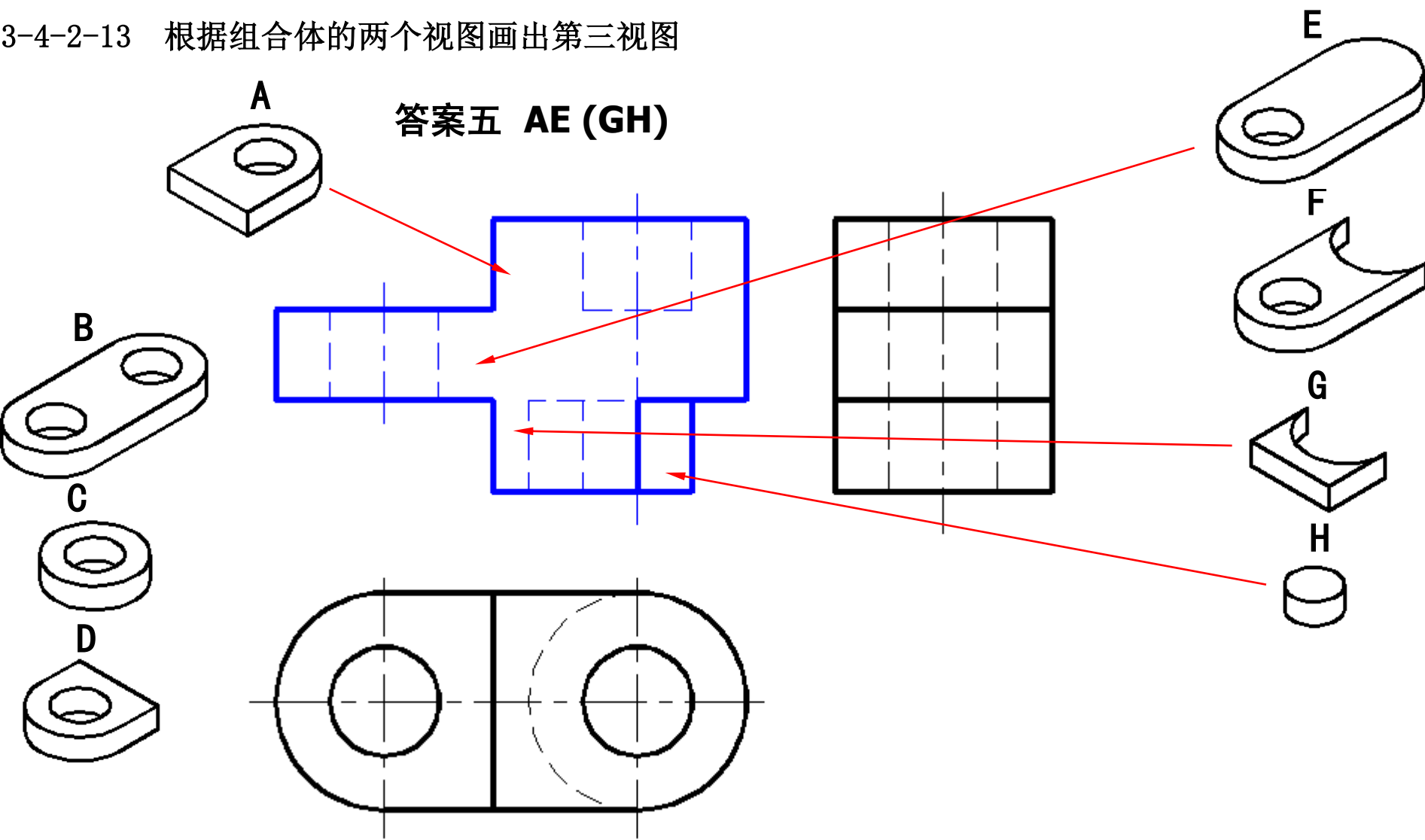

3-4-2-13 根据组合体的两个视图画出第三视图

答案六 AFA

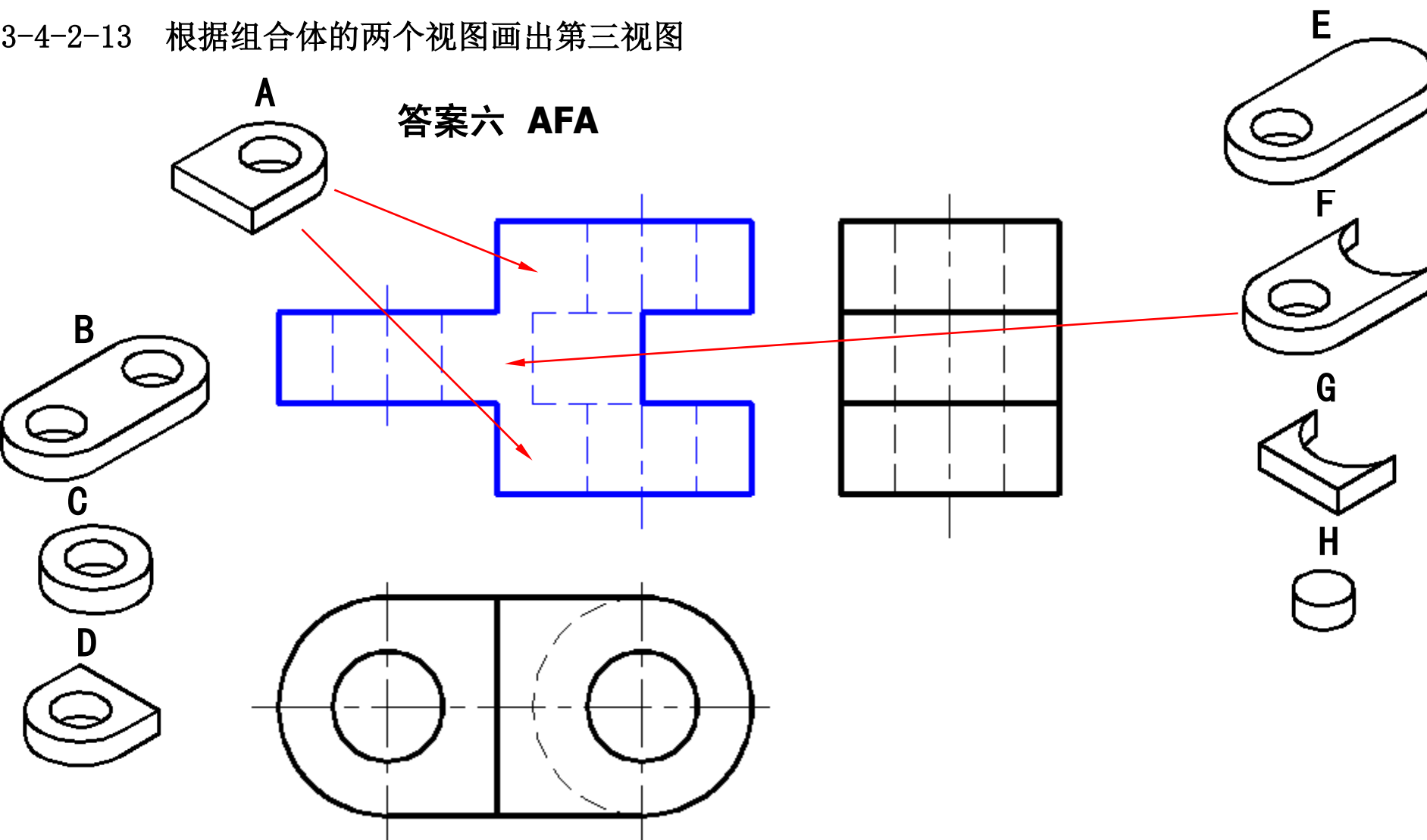

3-4-2-13 根据组合体的两个视图画出第三视图

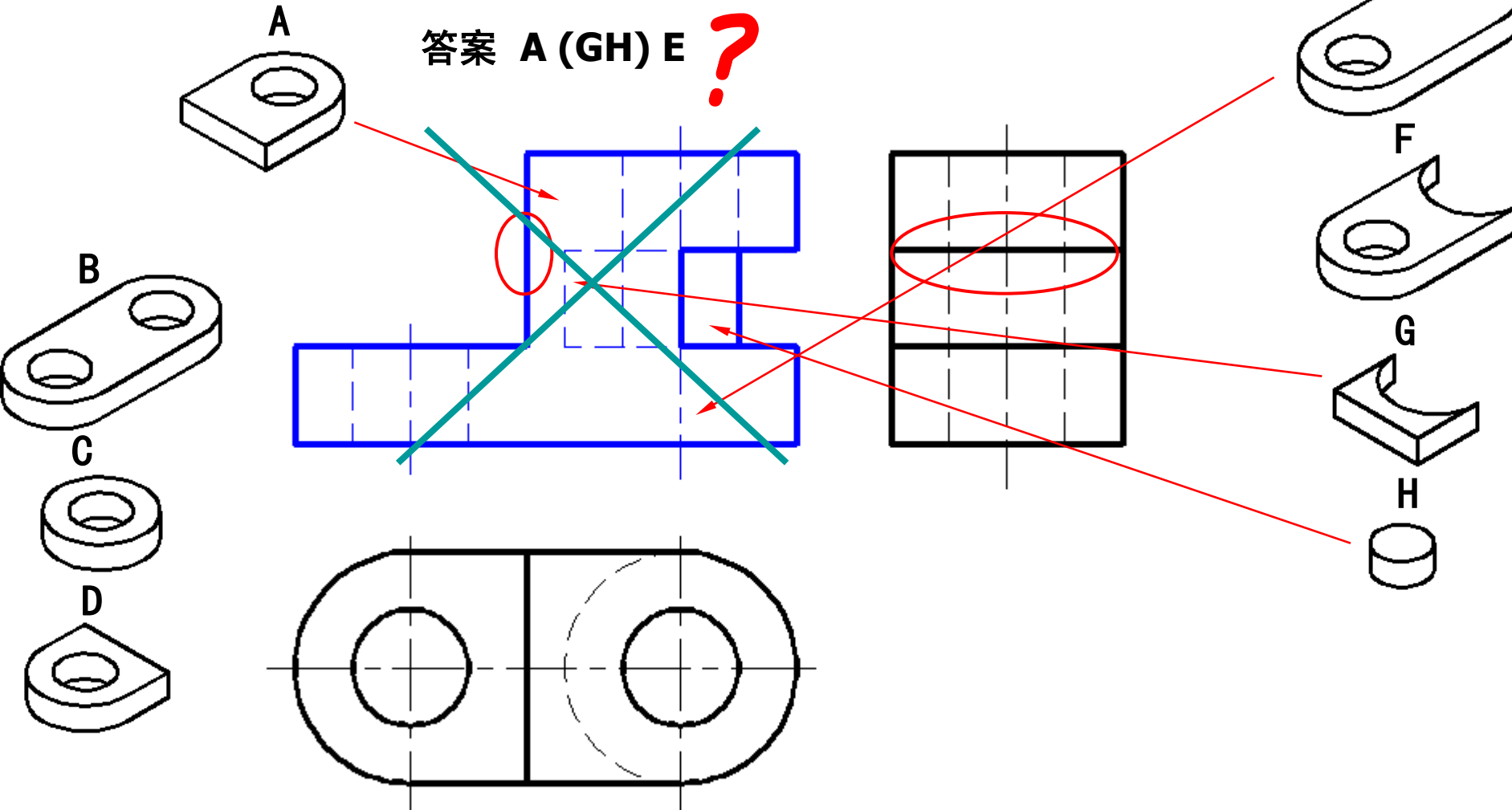

3-4-2-14 根据组合体的两个视图画出第三视图

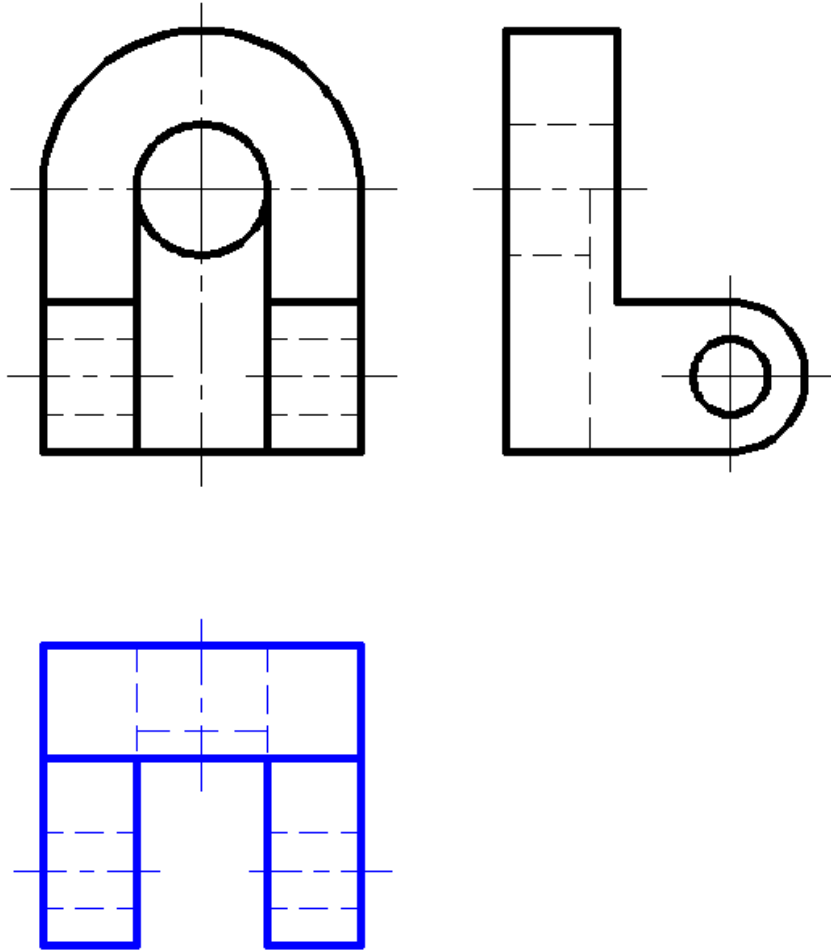

3-4-2-15 根据组合体的两个视图画出第三视图

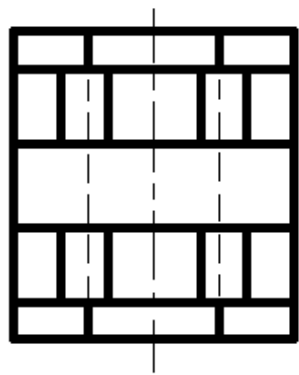
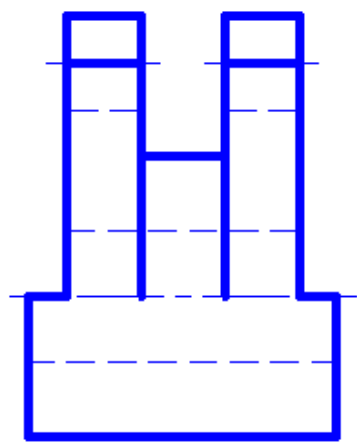
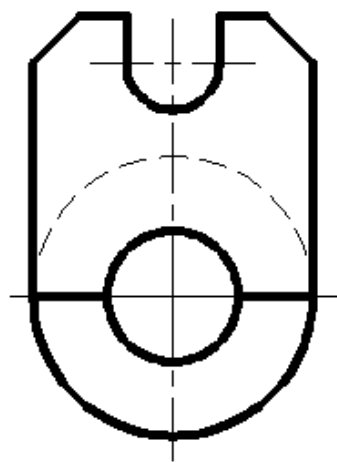

3-4-2-16 根据组合体的两个视图画出第三视图

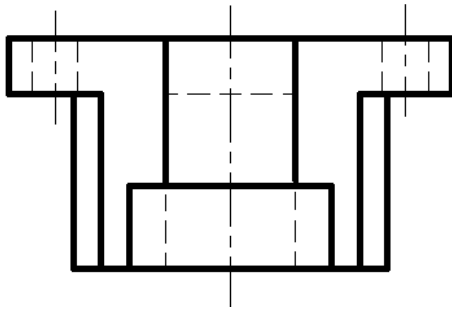
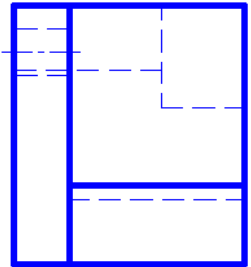
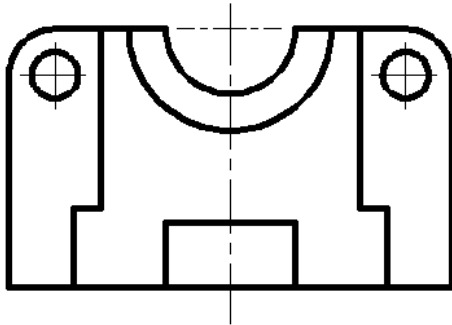

3-4-2-17 根据组合体的两个视图画出第三视图

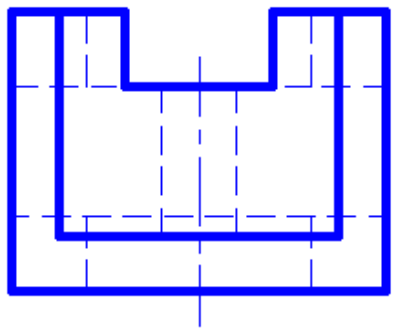
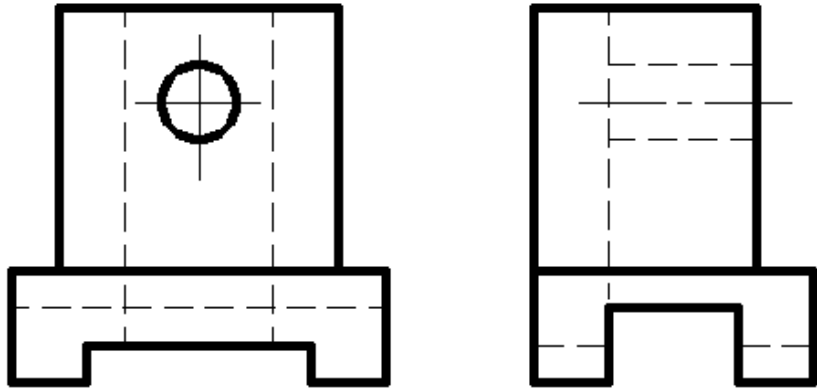



3-4-2-18 根据组合体的两个视图画出第三视图

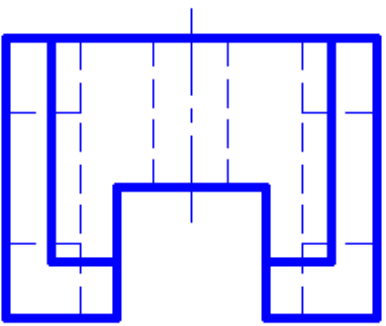
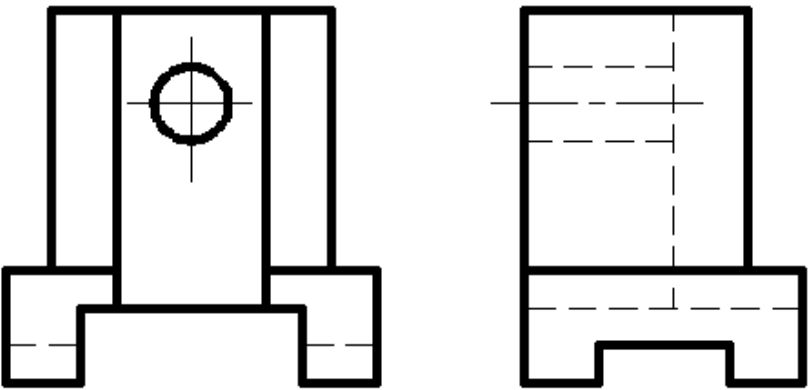

3-4-2-19 根据组合体的两个视图画出第三视图

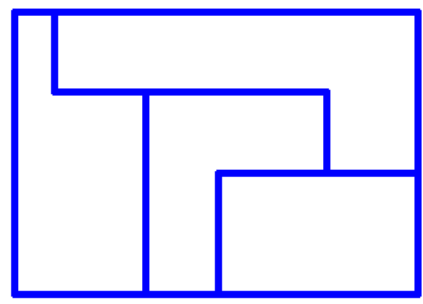
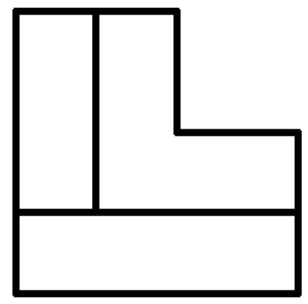
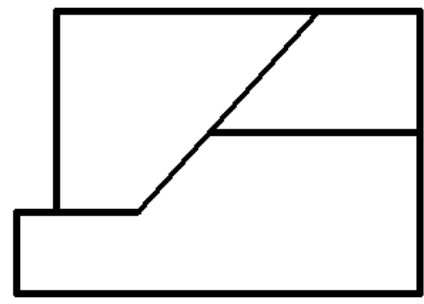

3-4-2-20 根据组合体的两个视图画出第三视图

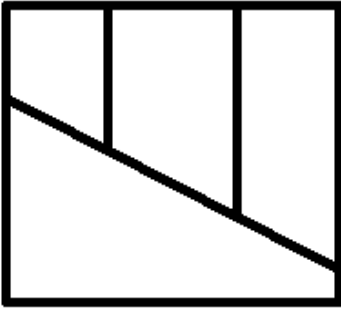
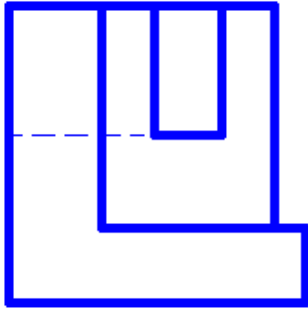
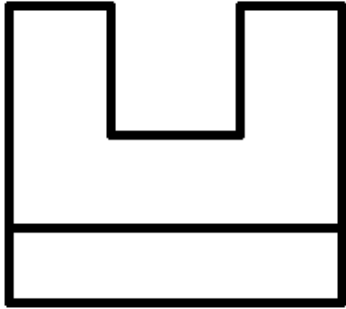

3-4-2-21 根据组合体的两个视图画出第三视图

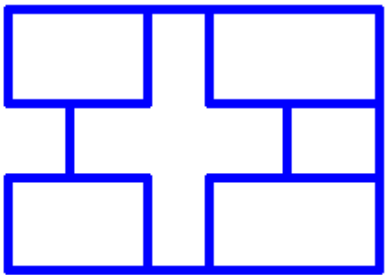
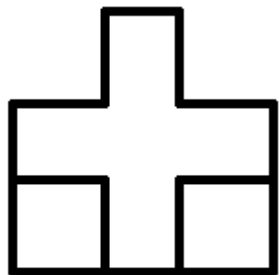
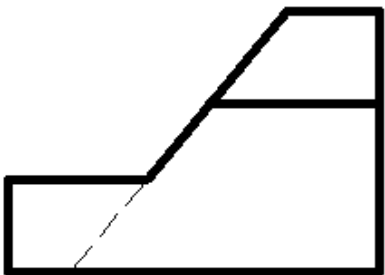

3-4-2-22 根据组合体的两个视图画出第三视图

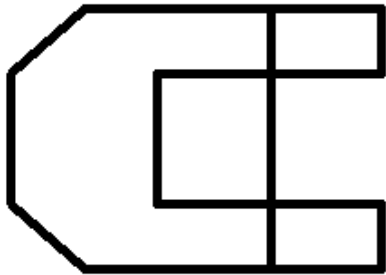
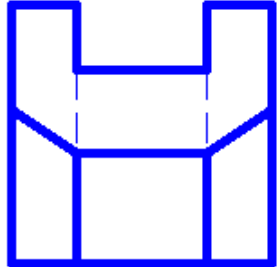
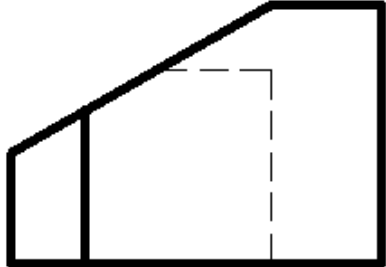

3-4-2-23 根据组合体的两个视图画出第三视图

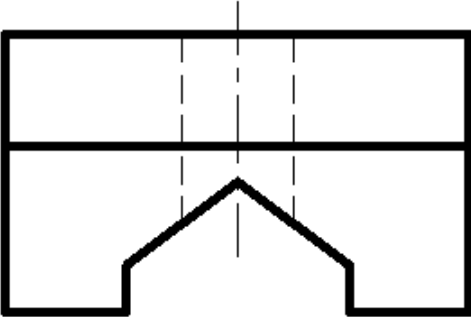
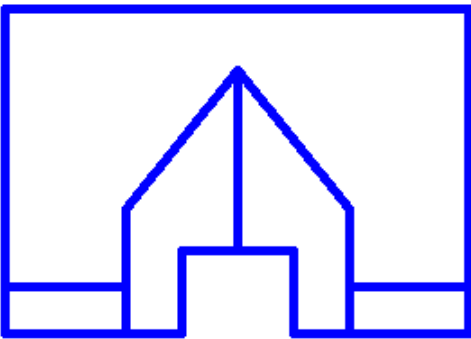

\*3-4-2-24 根据组合体的两个视图画出第三视图

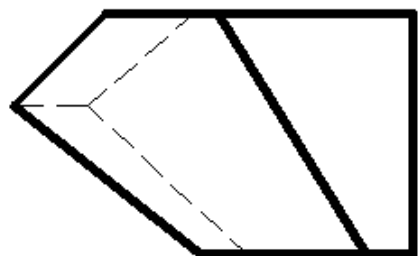
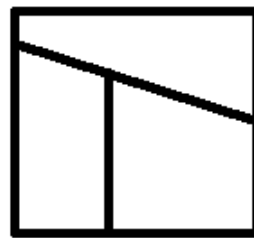
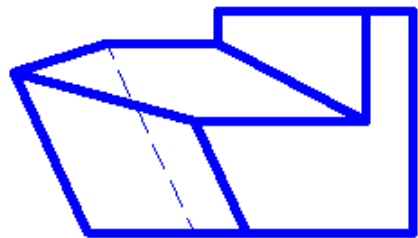

3-4-2-25 根据组合体的两个视图画出第三视图

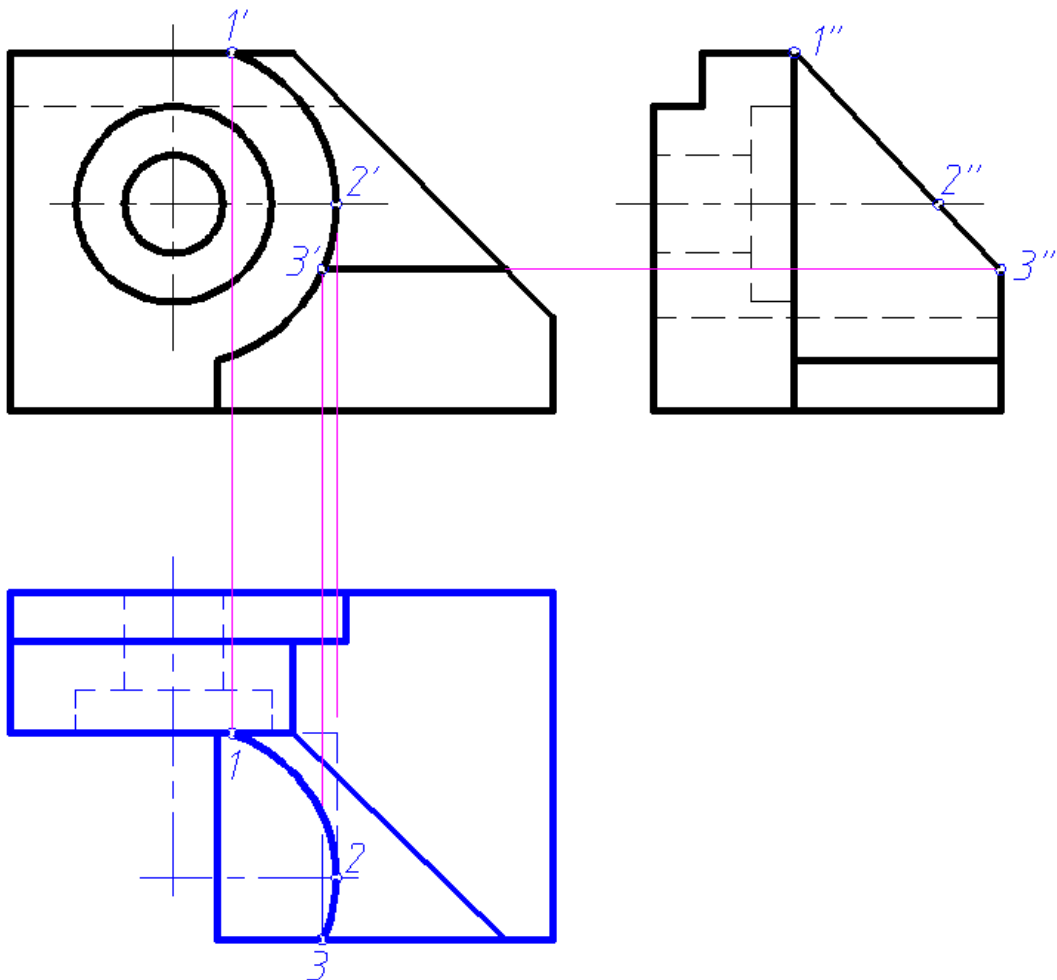



3-4-2-26 根据组合体的两个视图画出第三视图

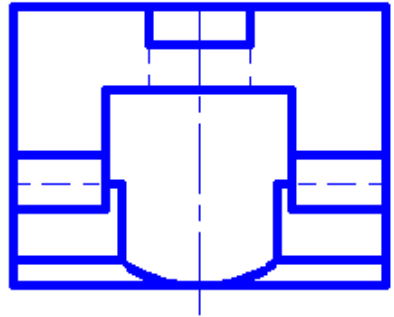
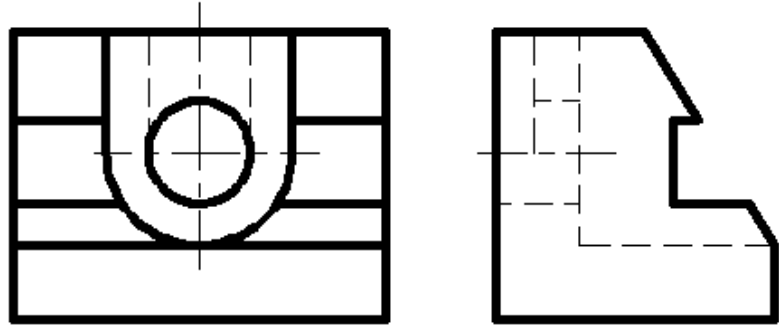

3-4-2-27 根据组合体的两个视图画出第三视图

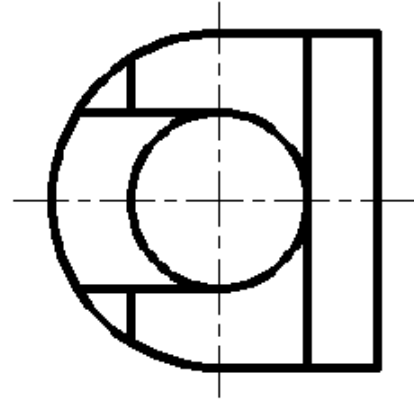
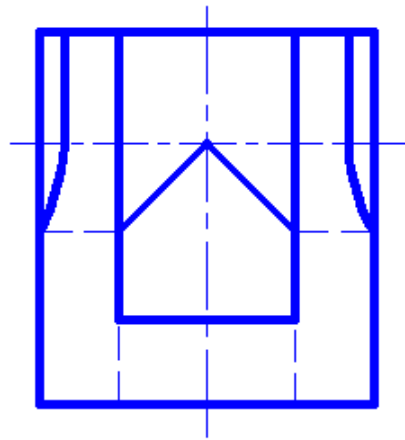
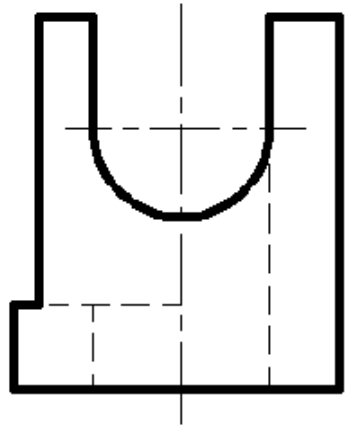

\*3-4-2-28 根据组合体的两个视图画出第三视图

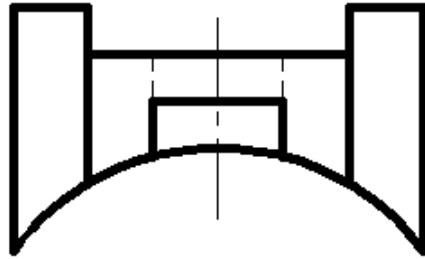
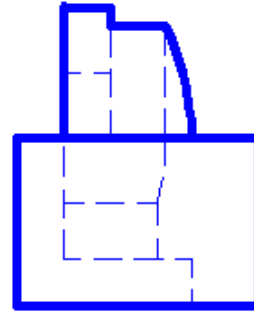
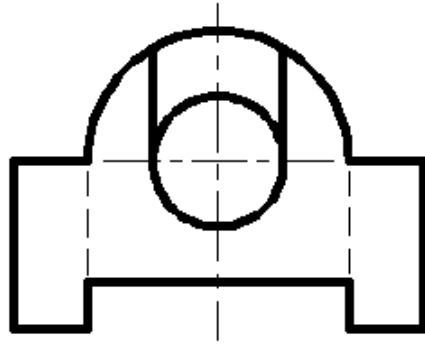

# 改正组合体视图中的错误

3-4-3-1 改正组合体视图中的错误(左视图正确)

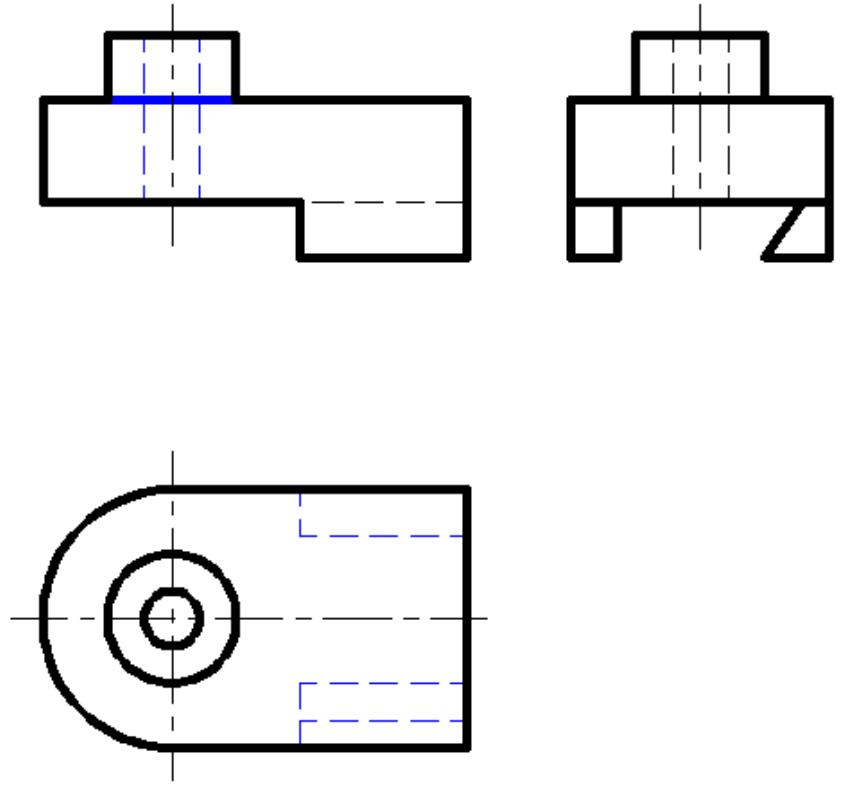

3-4-3-2 改正组合体视图中的错误(主视图正确)

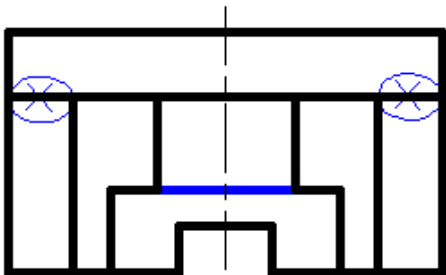
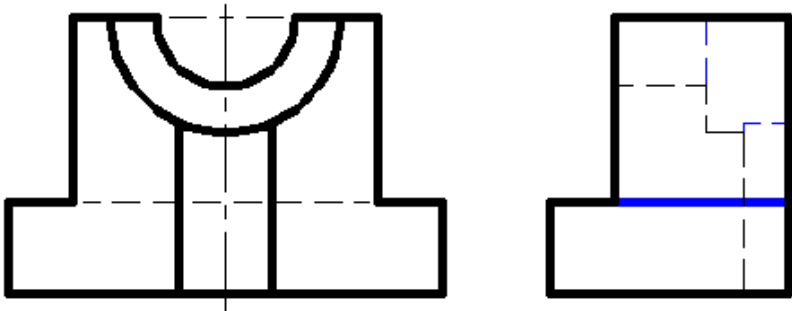

3-4-3-3 改正组合体视图中的错误(俯视图正确)

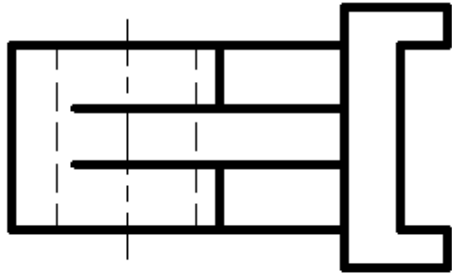
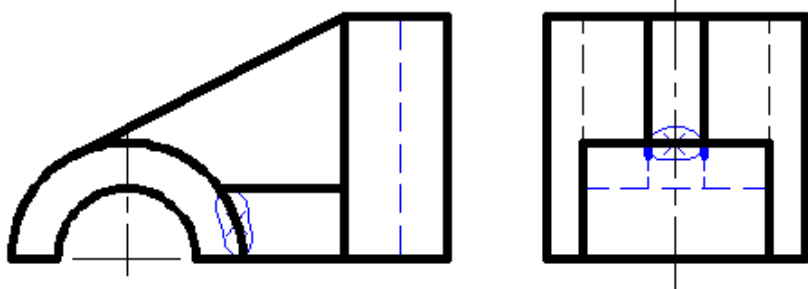

3-4-3-4 改正组合体视图中的错误(俯视图正确)

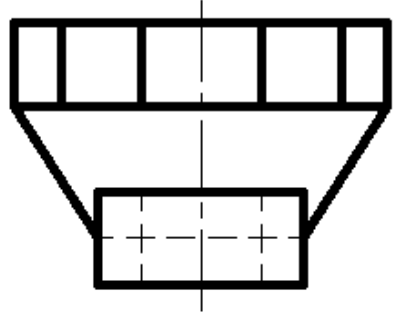
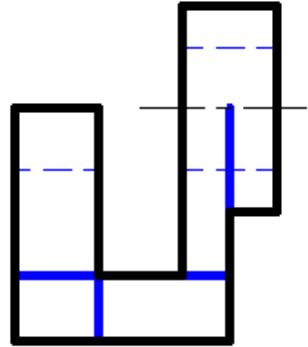
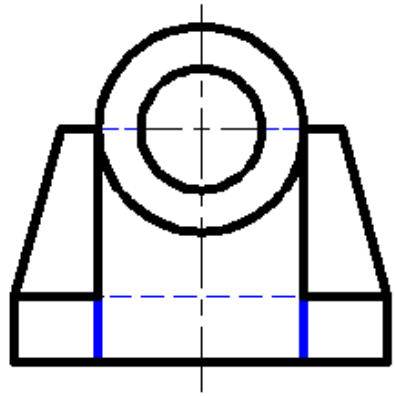



\*3-4-3-5 改正组合体视图中的错误(主视图正确)

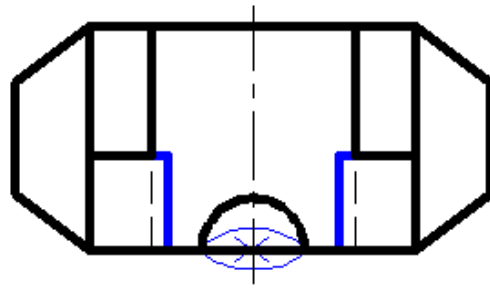
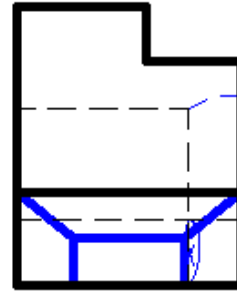
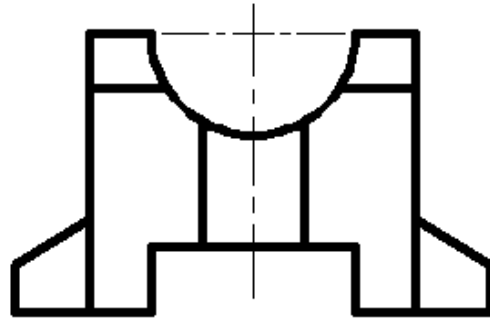

\*3-4-3-6 改正组合体视图中的错误(俯视图正确)

